





Quick Start Guide

version 1.0

Wireless Router

Package Contents

-  Wireless N Router
-  Quick Start Guide
-  Ethernet Cable
-  Power Adapter

Minimum Requirements

- Broadband Internet Service (Cable or DSL Modem)
- Internet Browser (Internet Explorer, Safari, Firefox, Chrome)
- Computer with Wireless 2.4 GHz or 5 GHz Adapter (IEEE 802.11a/b/g/n)

1

Unplug your **cable or DSL modem** and remove the **power adapter**.

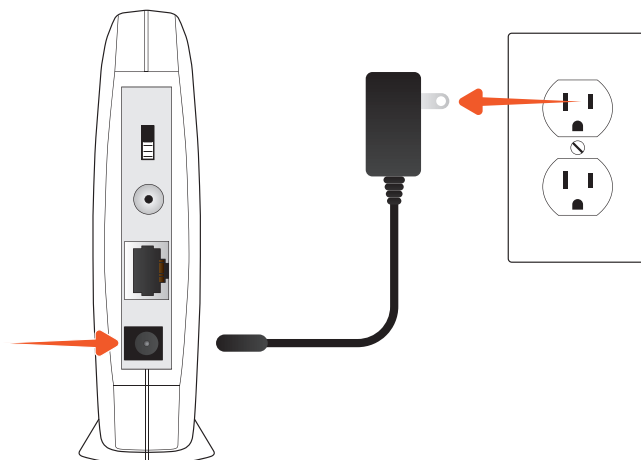

2

Plug one end of the included **gray Ethernet cable** into the **blue port labeled WAN** on the back of your router.



Plug the other end of the cable into the **Ethernet port** of your **modem**.

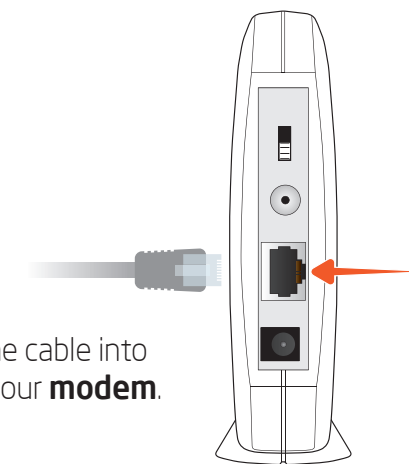

3

Reconnect the **power adapter** to your **cable or DSL modem** and plug into wall outlet.

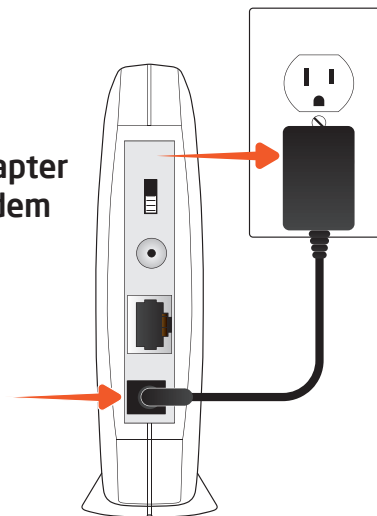

4

Connect the **power adapter** to your **router** and plug into wall outlet.

Wait for **2 minutes**.

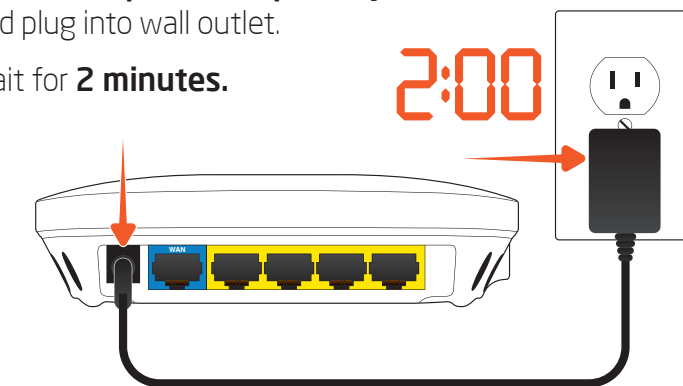

5

The preset **Wi-Fi Name and Password** are located on the bottom of your router.

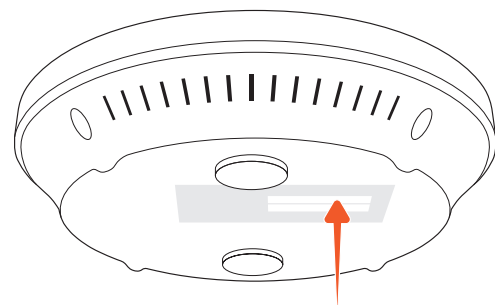

Wi-Fi Name (SSID) e.g. EnGenius
Wi-Fi Password e.g. 123456789

6

Open the wireless utility settings on your **PC, Mac,** or **mobile device** and connect to your network (Wi-Fi Name).



PC - located at lower right portion of your screen in sys tray

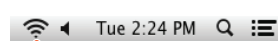

Mac - located at top right portion of your screen on menu bar

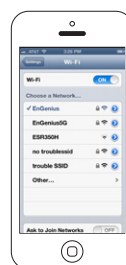

Mobile Device - iPhone shown

7

Open a Web browser on a **mobile device** or **computer**.

Type "**Engeniusrouter**" into a web browser.



Please follow the setup wizard to complete the installation steps.

Technical Support

Country of Purchase	Service Center	Service Information
North America www.EngeniusTech.com	Canada	rma@engeniustech.com Toll Free: (+1) 888 397 2788 Local: (+1) 905 940 8181
	Los Angeles, USA	support@engeniustech.com Toll Free: (+1) 888 735 7888 Local: (+1) 714 432 8668
Central & South America es.EngeniusTech.com pg.EngeniusTech.com	Miami, USA	miamisupport@engeniustech.com Miami: (+1) 305 887 7378 Sao Paulo, Brazil: (+55) 11 3957 0303 D.F. Mexico: (+52) 55 1163 8894
	Netherlands	support@enginiusnetworks.eu (+31) 40 8200 887
Africa CIS Middle East Russia www.Engenius-me.com	Dubai, UAE	support@enginius-me.com Toll Free: U.A.E.: 800-EnGenius 800-364-364-87 General: (+971) 4 357 5599
Asia Oceania www.EngeniusTech.com.sg	Singapore	www.EngeniusTech.com.sg/e_warranty_form techsupport@engeniustech.com.sg Toll Free: Singapore: 1800 364 3648
Others www.Engeniusnetworks.com	Taiwan, R.O.C.	technology@senao.com

Notes

Maximum data rates are based on IEEE 802.11 standards. Actual throughput and range may vary depending on many factors including environmental conditions, distance between devices, radio interference in the operating environment, and mix of devices in the network. Features and specifications subject to change without notice. Trademarks and registered trademarks are the property of their respective owners. For United States of America: Copyright © 2013 EnGenius Technologies, Inc. All rights reserved.